

**PROPOSED FIRST FLOOR PLAN**

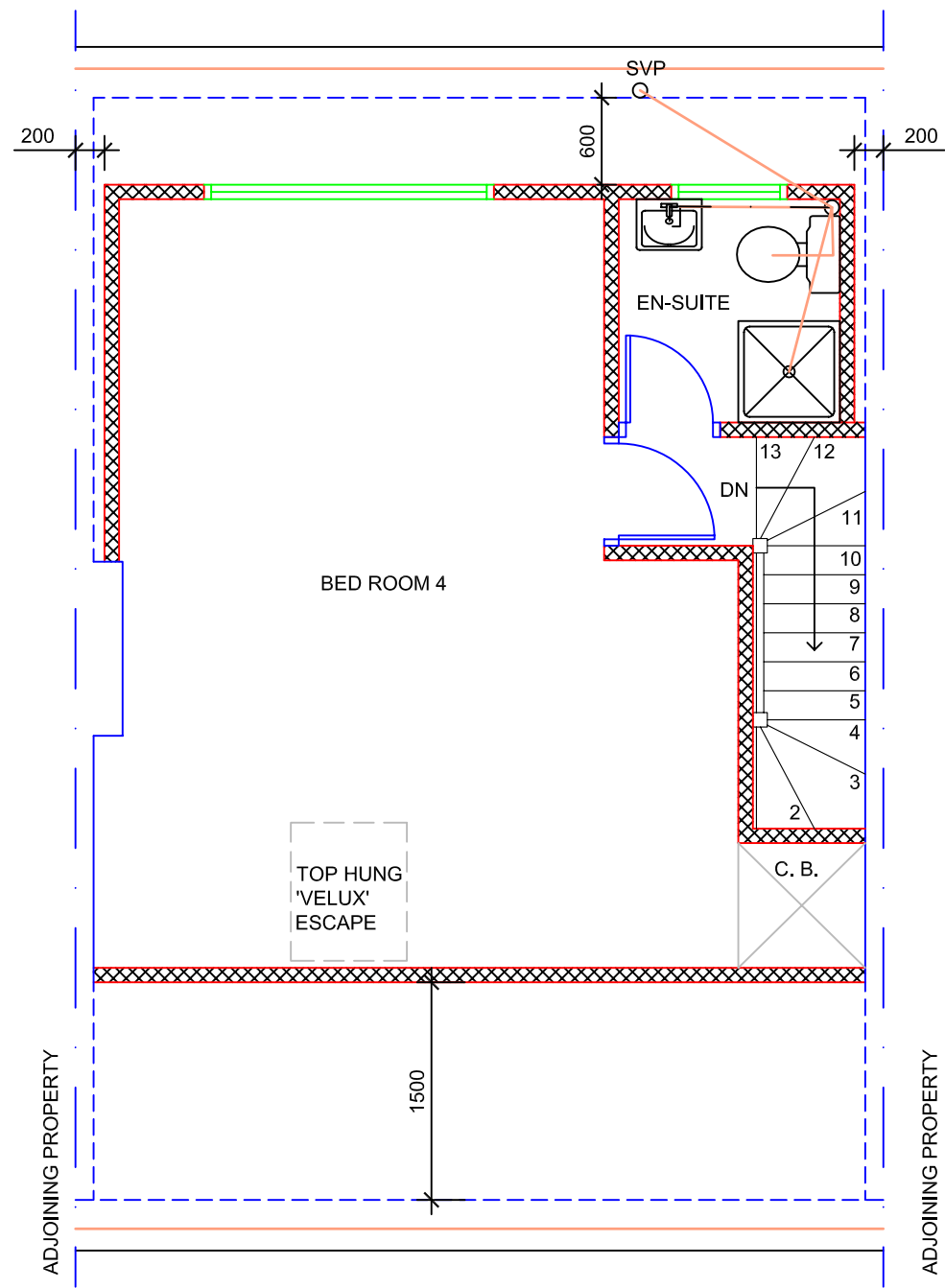

**PROPOSED LOFT PLAN**

**NOTES**

1. The staircase fabricating contractor to check and verify on site all the dimensions and headroom prior to commencement of any works. The contractor must ensure that the staircase fits within the structure and in full compliance with the Building Control requirements.
- If the wall to bed 3 requires to be moved this must be brought to the attention of the client.
2. all surface and foul water drainage to be verified and agreed on site with b.c. officer.
3. Soil Vent pipe to be raised 900mm above the dormer window.
4. No changes are proposed to the existing boiler installation.
5. Electrical safety certificate must be submitted upon completion of works.

**Revisions**

All dimensions and particulars are to be checked on site before work commences and any discrepancy to be reported to THE SURVEYOR.  
DO NOT SCALE off this drawing, use written dimensions only.

Project  
**PROPOSED LOFT  
CONVERSION AT**

Drawing  
**PROPOSED FIRST &  
LOFT FLOOR PLAN**

Number	Revisions
2012/50/02	A

Date	Scale
FEB. 2012	1:50

Client  
**MR. DAVID JONES**